

**BOTANICA
LUXURY**
VILLAS



Real image with simulated atmosphere for advertisement purposes only

ABOUT US

Botanica Luxury Villas stand as a beacon of luxury and excellence in Phuket's real estate market, boasting nearly two decades of unparalleled expertise. With a portfolio featuring over 30 distinguished projects, both in Phuket and beyond, we have consistently set new standards in luxury living. Our unique and exceptional architectural designs are a testament to our commitment to innovation and quality, making us a premier choice for discerning buyers and investors.

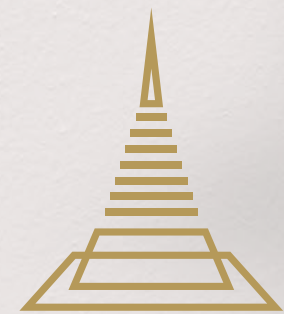

**BOTANICA
LUXURY**
VILLAS

20

YEARS EXPERIENCE
LUXURY POOL VILLAS



BOTANICA
LUXURY
VILLAS

VISION

At Botanica Luxury Villas, our vision transcends conventional real estate development. We are dedicated to shaping the future of luxury living in Phuket and beyond with a holistic approach that encompasses urban planning, environmental stewardship, and community enhancement. Our vision is anchored in three core aspirations.



BOTANICA
LUXURY
VILLAS

BOTANICA TEAM



CONCEPTS
OF SUSTAINABLE
HAPPINESS



OUR COMMITMENT

At Botanica Luxury Villas, our dedication transcends business; we are profoundly committed to the holistic development and well-being of Phuket. As proud local developers, we play a pivotal role in fostering the growth of our community, enhancing social welfare, supporting local people, and protecting our environment. We don't just build homes; we create exquisite masterpieces of visual splendor and meticulous craftsmanship, ensuring supreme comfort and a lavish lifestyle in prime locations. With an unwavering passion to elevate Phuket and Thailand onto the global stage, we maintain harmony with our communities. Our deep-rooted connection to nature drives us to pursue sustainable development that enriches every facet of life. At Botanica, we don't just build; we create a legacy of living, nature, and luxury. Create your Botanica, create your difference.



NATURE

Nature is a boon to humankind and consists of various natural resources such as air, water, soil, and more which are all necessary for life on earth. Nature consists of both biotic and abiotic elements which together make up nature. Biotic factors consist of living things such as plants, and animals, abiotic factors are physical rather than biological. At Botanica Luxury Villas we combine both biotic and abiotic elements to serve you and create the perfect environment for living. Discover all our Luxury Villa projects



DESIGN

At Botanica Luxury Villas we have poured our vision and experience into three main designs. Botanica Modern Luxury, Botanica Modern Loft, and Botanica's signature classic Tropical Balinese. All three designs are artwork and masterpieces from our CEO, who as an architect, lives to delight, inspire and transform. Their sole purpose is to create the perfect natural living environment for you and your family to enjoy.



QUALITY

Through intelligent orientation we consider, plan and create every aspect when designing our luxury villa projects. By sourcing only the highest quality products and paying attention to every minute detail we ensure that our villas are unparalleled and in a class on their own.

BOTANICA COMMUNITY

The Legacy of Living , Nature and Luxury.
Create Your Botanica, Create Your Difference.



Real image with simulated atmosphere for advertisement purposes only



Real image with simulated atmosphere for advertisement purposes only



Real image with simulated atmosphere for advertisement purposes only



TO ENHANCE THE ENVIRONMENT AND UPLIFT THE QUALITY OF LIFE FOR THE LOCAL COMMUNITY

We are committed to improving the environment through sustainable development practices. Our projects are designed to harmonize with nature, preserving the natural beauty of their surroundings while incorporating green technologies and eco-friendly materials. Additionally, we focus on improving the quality of life for the local community by creating job opportunities, supporting local businesses, and contributing to community development initiatives.

Through these visionary goals, Botanica Luxury Villas is not just building homes but crafting a legacy of sustainable luxury and community well-being.



**BOTANICA
LUXURY**
VILLAS

OUR MILESTONES

2004

Botanica Luxury Villas Phase I
Project Development Starting our 1st sale

2012

Botanica Luxury Villas
Phase II

2016

Botanica Luxury Villas
Phase IV

2006

Botanica Luxury Villas Phase I
Starting construction
Project Sold out

2014

Botanica Luxury Villas
Phase III

2018

Botanica Bangtao Beach
Launched And Sold Out

2019

Botanica The Valley
Botanica The Nature
Botanica Lakeside
Botanica Foresta

2021

Botanica Modern Loft

2022

GOLDEN YEAR
Record-breaking
5,500 MB in sales.
Botanica Sky Valley
Botanica Modern Loft II
Botanica Lakeside II
Botanica Forestique

2023

Botanica Zen
Project Launch February, 2023
Project Sold Out March, 2023
Botanica Prestige
Botanica Grand Avenue
Botanica Hillside
Botanica Foresta II
Botanica Four Seasons Spring
Botanica Four Seasons Summer
Botanica Four Seasons Autumn
Botanica MontAzure

2024

PINNACLE ACHIEVEMENT
In January 2024, we broke another record by achieving
1,200 MB in sales.
Project Launch
Botanica Louvre, Hythe By Botanica, Botanica Wisdom
Botanica Foresta
Project Sold Out 9 August, 2024
20TH ANNIVERSARY CELEBRATION
In 21 December 2024
Project Launch
Botanica Modern Sea Karon

2025

Botanica Hillside
Project Sold Out 14 January, 2025
Project Launch
Botanica Chalong Bay
Botanica Green Boulevard



KEY ACHIEVEMENTS

Our legacy is marked by over 30 successfully developed and sold projects, earning numerous accolades that highlight our commitment to quality, innovation, and excellence. We have built a sterling reputation for creating unique and outstanding architectural designs that continue to set us apart in the luxury real estate market.

1st
HIGHEST MARKET SHARE
AMONG VILLA DEVELOPERS*

1.1M^{M2}
OF DEVELOPMENT PROJECTS IN PHUKET
PROJECT VALUE

51+
BILLION
PROJECT VALUE

9+
ARCHITECTURAL
DESIGNS STYLE

30
SUCCESSFULLY
DEVELOPED PROJECTS

19+
AWARDS WINNER
PROPERTY DEVELOPMENT

*Collier Thailand research, as of May 2024 / Phuket- The villa supply stands at 3,419 units. (2012-2024F) / Botanica Luxury Villa offering a supply of 1,095 units.



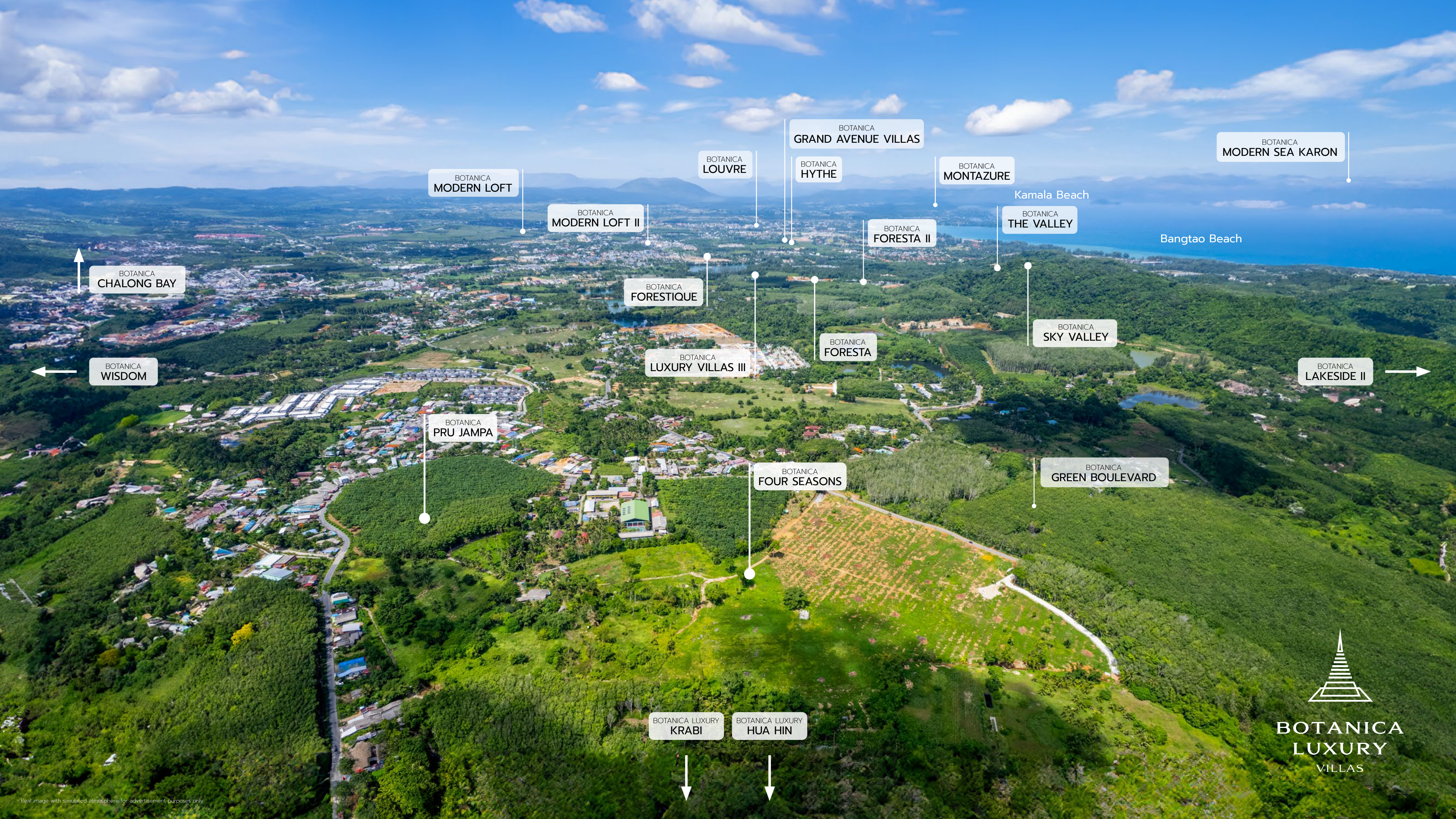

BOTANICA
CHALONG BAY

BOTANICA
WISDOM

BOTANICA
MODERN LOFT

BOTANICA
MODERN LOFT II

BOTANICA
FORESTIQUE

BOTANICA
LUXURY VILLAS III

BOTANICA
PRU JAMPA

BOTANICA
LOUVRE

BOTANICA
GRAND AVENUE VILLAS

BOTANICA
HYTHE

BOTANICA
FORESTA II

BOTANICA
FORESTA

BOTANICA
FOUR SEASONS

BOTANICA LUXURY
KRABI

BOTANICA LUXURY
HUA HIN

BOTANICA
MONTAZURE

BOTANICA
THE VALLEY

BOTANICA
SKY VALLEY

BOTANICA
GREEN BOULEVARD

BOTANICA
MODERN SEA KARON

BOTANICA
LAKESIDE II

Kamala Beach

Bangtao Beach



BOTANICA
LUXURY
VILLAS

OUR PROJECTS

ON MARKET IN PHUKET

1. BOTANICA LAKESIDE
2. BOTANICA FORESTIQUE
3. BOTANICA SKY VALLEY
4. BOTANICA MODERN LOFT II
5. BOTANICA LAKESIDE II
6. BOTANICA FORESTA II
7. BOTANICA FOUR SEASONS
8. BOTANICA MONTAZURE
9. BOTANICA PRESTIGE
10. BOTANICA GRAND AVENUE
11. HYTHE BY BOTANICA
12. BOTANICA LOUVRE
13. BOTANICA WISDOM
14. BOTANICA PRU JAMPA
15. BOTANICA MODERN SEA KARON
16. BOTANICA CHALONG BAY
17. BOTANICA GREEN BOULEVARD

PROJECTS OUTSIDE PHUKET

18. BOTANICA LUXURY HUA HIN
19. BOTANICA LUXURY KRABI

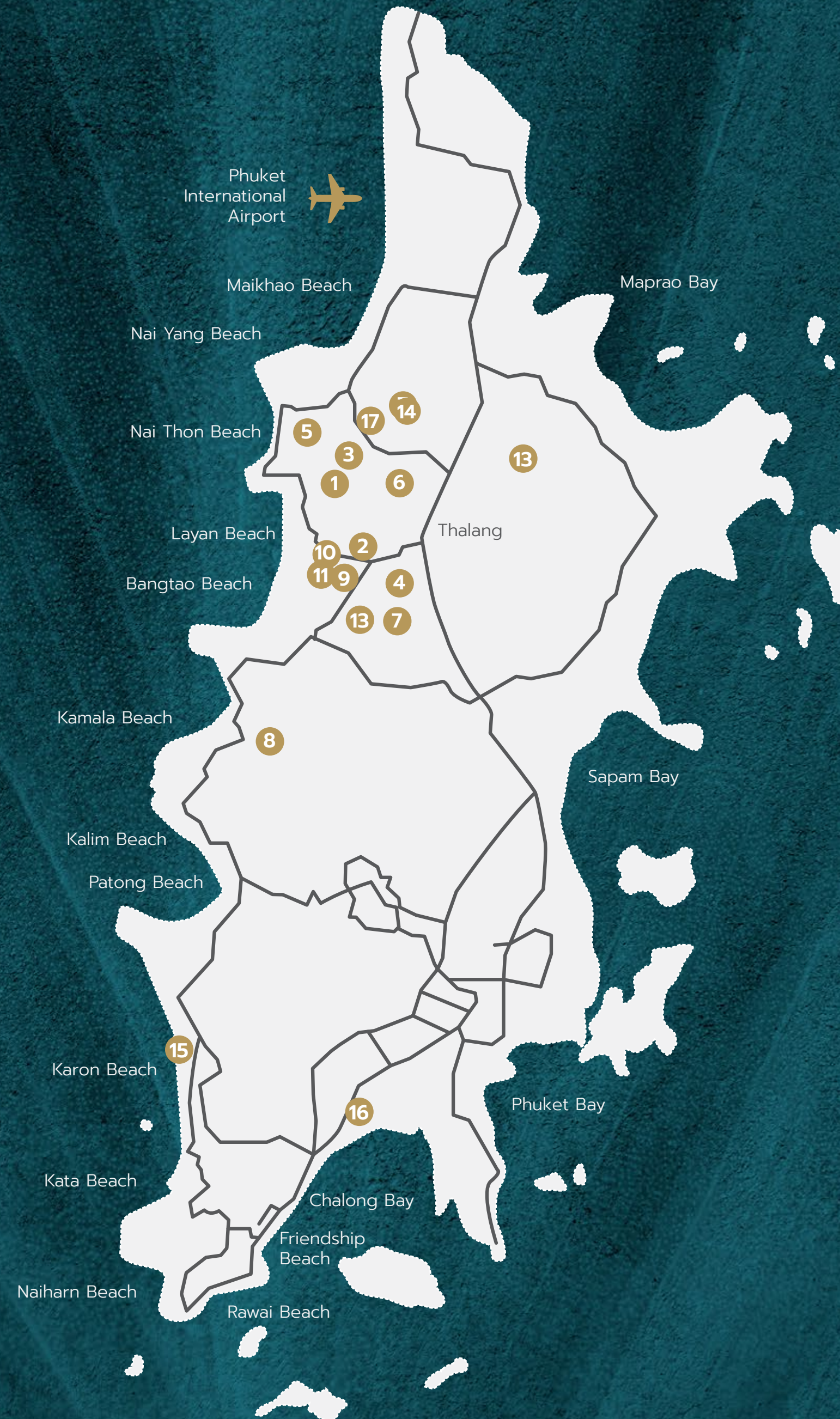

11+

SOLD OUT
PROJECTS

17+

PROJECTS
PHUKET

2+

PROJECTS
OUTSIDE PHUKET
KRABI
HUA HIN

1.3K+

TOTAL UNITS
DEVELOPER



100%

SOLD OUT
LUXURY POOL VILLAS



BOTANICA LUXURY VILLAS

Total Units 7 Villas



BOTANICA LUXURY VILLAS II

Total Units 5 Villas



BOTANICA LUXURY VILLAS III

Total Units 19 Villas



BOTANICA LUXURY VILLAS IV

Total Units 14 Villas



BOTANICA BANGTAO BEACH

Total Units 23 Villas



BOTANICA THE VALLEY

Total Units 13 Villas



BOTANICA THE NATURE

Total Units 9 Villas



BOTANICA MODERN LOFT

Total Units 39 Villas



BOTANICA ZEN

Total Units 10 Villas

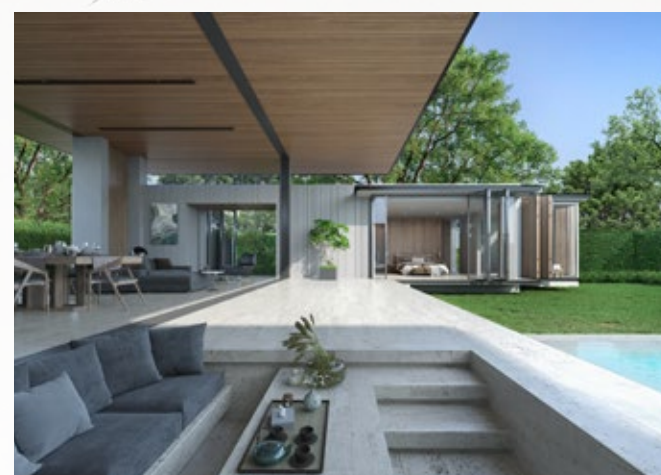

BOTANICA FORESTA

Total Units 83 Villas



BOTANICA HILLSIDE

Total Units 12 Villas

CURRENT PROJECTS



BOTANICA LAKESIDE

Total Units 15 Villas
 The land size start 459 - 1,092 sq.m.
 Built-up Size Starts 305 sq.m.

COMMON AREA

Total Project Area 285,017 sq.m.
 Driving Area 10,421 sq.m.
 Footpath 14,368 sq.m.
 Garden Area 5,938 sq.m.



BOTANICA FORESTIQUE

Total Units 65 Villas
 The Land Size Starts 654 - 1,115 sq.m.
 Built-up Size Starts 318 sq.m.

COMMON AREA

Total Project Area 81,600 sq.m.



BOTANICA SKY VALLEY

Total Units 29 Villas
 The Land Size Starts 719 - 1,755 sq.m.
 Built-up Size Starts 547 sq.m.

COMMON AREA

Total Project Area 49,246 sq.m.
 Driving Area 5,062 sq.m.
 Footpath 1,806 sq.m.
 Garden Area 8,359 sq.m.



BOTANICA MODERN LOFT II

Total Units 54 Villas
 The Land Size Starts 462 - 878 sq.m.
 Built-up Size Starts 296 sq.m.

COMMON AREA

Total Project Area 36,995 sq.m.
 Driving Area 5,184 sq.m.
 Footpath 2,222 sq.m.
 Garden Area 2,154 sq.m.



BOTANICA LAKESIDE II

Total Units 18 Villas
 The Land Size Starts 460 - 1,117 sq.m.
 Built-up Size Starts 298 sq.m.

COMMON AREA

Total Project Area 13,000 sq.m.
 Driving Area 1,300 sq.m.
 Footpath 425 sq.m.
 Garden Area 808 sq.m.



BOTANICA FORESTA II

Total Units 32 Villas
 The Land Size Starts 480 - 1,535 sq.m.
 Built-up Size Starts 405 sq.m.

COMMON AREA

Total Project Area 61,449 sq.m.
 Driving Area 8,926 sq.m.
 Footpath 6,555 sq.m.
 Garden Area 3,762 sq.m.

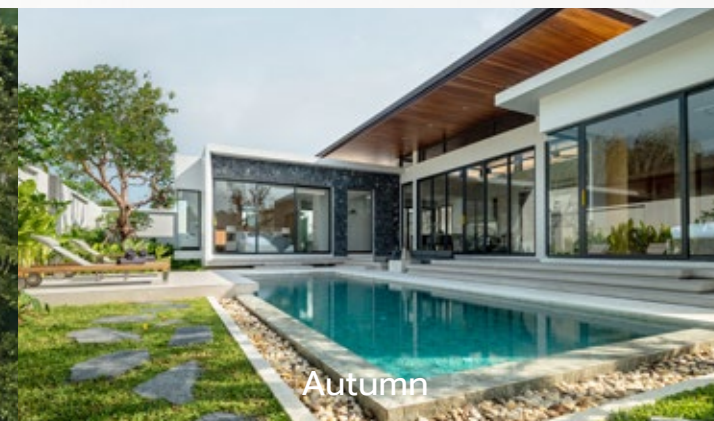
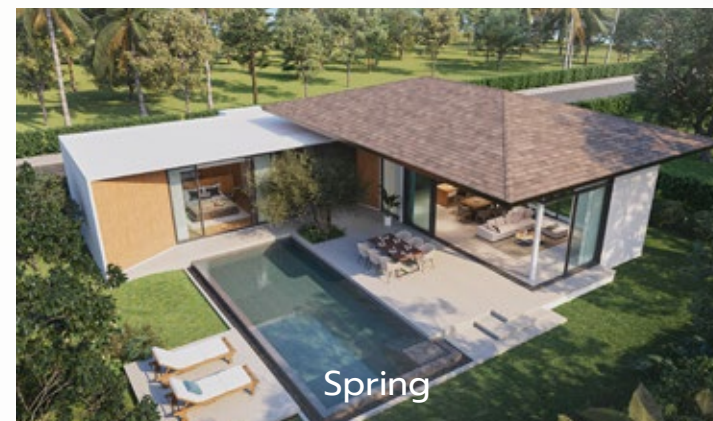

BOTANICA FOUR SEASONS

SPRING I, II, III

Total Units 138 Villas
 The Land Size Starts 462 - 1,172 sq.m.
 Built-up Size Starts 305 sq.m.

COMMON AREA

Total Project Area 21,942 - 51,255 sq.m.
 Driving Area 2,958 - 8,198 sq.m.
 Footpath 1,308 - 2,424 sq.m.
 Garden Area 657 - 1,962 sq.m.

SUMMER I, II

Total Units 58 Villas
 The Land Size Starts 547 - 1,276 sq.m.
 Built-up Size Starts 370 sq.m.

COMMON AREA

Total Project Area 18,400 - 34,467 sq.m.
 Driving Area 2,438 - 4,337 sq.m.
 Footpath 737 - 1,579 sq.m.
 Garden Area 932 - 1,705 sq.m.

AUTUMN I, II

Total Units 71 Villas
 The Land Size Starts 448 - 800 sq.m.
 Built-up Size Starts 310 sq.m.

COMMON AREA

Total Project Area 24,407 - 26,289 sq.m.
 Driving Area 3,872 - 3,344 sq.m.
 Footpath 1,049 - 1,412 sq.m.
 Garden Area 970 - 1,058 sq.m.

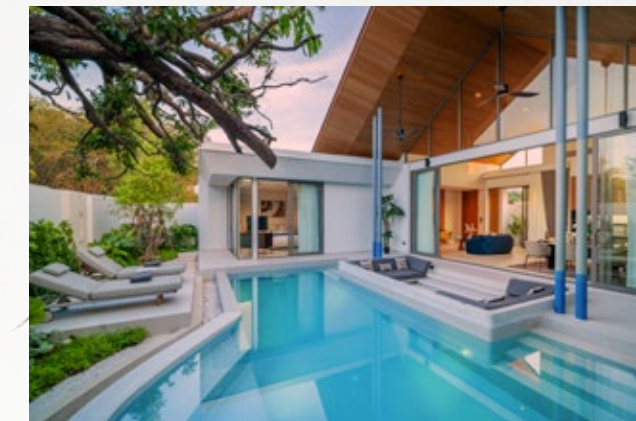

BOTANICA LOUVRE

Total Units 8 Villas
 The Land Size Starts 435 - 560 sq.m.
 Built-up Size Starts 336 sq.m.



BOTANICA GRAND AVENUE

Total Units 153 Villas
 The Land Size Starts 459 - 1,092 sq.m.
 Built-up Size Starts 305 sq.m.

COMMON AREA

Total Project Area 285,017 sq.m.
 Driving Area 10,421 sq.m.
 Footpath 14,368 sq.m.
 Garden Area 5,938 sq.m.

CURRENT PROJECTS



HYTHE BY BOTANICA

CONDOMINIUM	
Building	4
Tower A	66 Units
Tower B	72 Units
Tower C	72 Units
Tower D	66 Units
Total Units	276 Units
The Land Size Starts	59.52 sq.m.



BOTANICA PRESTIGE

Total Units	7 Villas
The Land Size Starts	601 - 830 sq.m.
Built-up Size Starts	373 sq.m.
COMMON AREA	
Total Project Area	7,049 sq.m.
Driving Area	379 sq.m.
Footpath	602 sq.m.
Garden Area	195 sq.m.



BOTANICA MONTAZURE

Total Units	36 Villas.
The Land Size Starts	719 sq.m.
Built-up Size Starts	453 sq.m.
COMMON AREA	
Total Project Area	16,213 sq.m.
Driving Area	1,413 sq.m.
Footpath	906 sq.m.
Garden Area	653 sq.m.



BOTANICA LUXURY HUA HIN

Total Units	30 Villas
The Land Size Starts	500 - 798 sq.m.
Built-up Size Starts	310 sq.m.
COMMON AREA	
Total Project Area	22,458 sq.m.
Driving Area	3,595 sq.m.
Footpath	1,048 sq.m.
Garden Area	387 sq.m.



BOTANICA LUXURY KRABI

Total Units	25 Villas
The Land Size Starts	455 - 774 sq.m.
Built-up Size Starts	310 sq.m.
COMMON AREA	
Total Project Area	17,604 sq.m.
Driving Area	2,318 sq.m.
Footpath	715 sq.m.
Garden Area	878 sq.m.



BOTANICA WISDOM

Total Units	68 Villas
The Land Size Starts	461 - 984 sq.m.
Built-up Size Starts	320 sq.m.
COMMON AREA	
Total Project Area	49,604 sq.m.
Driving Area	6,885 sq.m.
Footpath	2,285 sq.m.
Green&Garden Area	3,329 sq.m.



BOTANICA PRU JAMPA

Total Units	89 Villas
The Land Size Starts	360 - 637 sq.m.
Built-up Size Starts	280 sq.m.
COMMON AREA	
Total Project Area	52,244 sq.m.
Driving Area	6,728 sq.m.
Footpath	1,911 sq.m.
Garden Area	3,050 sq.m.



BOTANICA MODERN SEA KARON

Total Units Phase 1	6 Villas
COMMON AREA	
Total Project Area	17,609 sq.m.
Land Area	386 - 772 sq.m.
Usable Area	660 - 702 sq.m.



BOTANICA CHALONG BAY

Total Units	13 Villas
The Land Size Starts	459 - 1,298 sq.m.
Usable Area Starts	431 - 645 sq.m.
COMMON AREA	
Total Project Area	24,412 sq.m.
Driving Area	2,762 sq.m.
Driving Area & Footpath	4,021 sq.m.
Garden Area	875 sq.m.



BOTANICA GREEN BOULEVARD

Total Units	139 Villas
The Land Size Starts	520 - 1,365 sq.m.
Built-up Size Starts	380 sq.m.
COMMON AREA	
Total Project Area	149,594 sq.m.
Driving Area	19,784 sq.m.
Driving Area & Footpath	7,850 sq.m.
Garden Area	7,377 sq.m.



NEW PROJECT
COMING SOON



NEW PROJECT
COMING SOON



BOTANICA GRAND AVENUE



DISCLAIMER: The advertised images and its contents are real and/or be for illustration purposes. Information contained in this sales and marketing material as shown herein are to be used for the purposes of advertising and guideline only. Any information, terms and conditions will be reserved the right to change at any time without prior notice. Reproduction, distribution, photocopy, adaptation, communication to public, publication, exploitation of all or any parts hereof and or retransmission of material contained without permission is prohibited.

ZONE A1		ZONE B	
Total Units	42 Villas	Total Units	12 Villas
Total Project Area	74,994 sq.m.	Total Project Area	17,119 sq.m.
Road And Facility	21,781 sq.m.	Road And Facility	3,510 sq.m.
ZONE A2		ZONE C1	
Total Units	30 Villas	Total Units	43 Villas
Total Project Area	25,948 sq.m.	Total Project Area	31,058 sq.m.
Road And Facility	7,321 sq.m.	Road And Facility	7,297 sq.m.

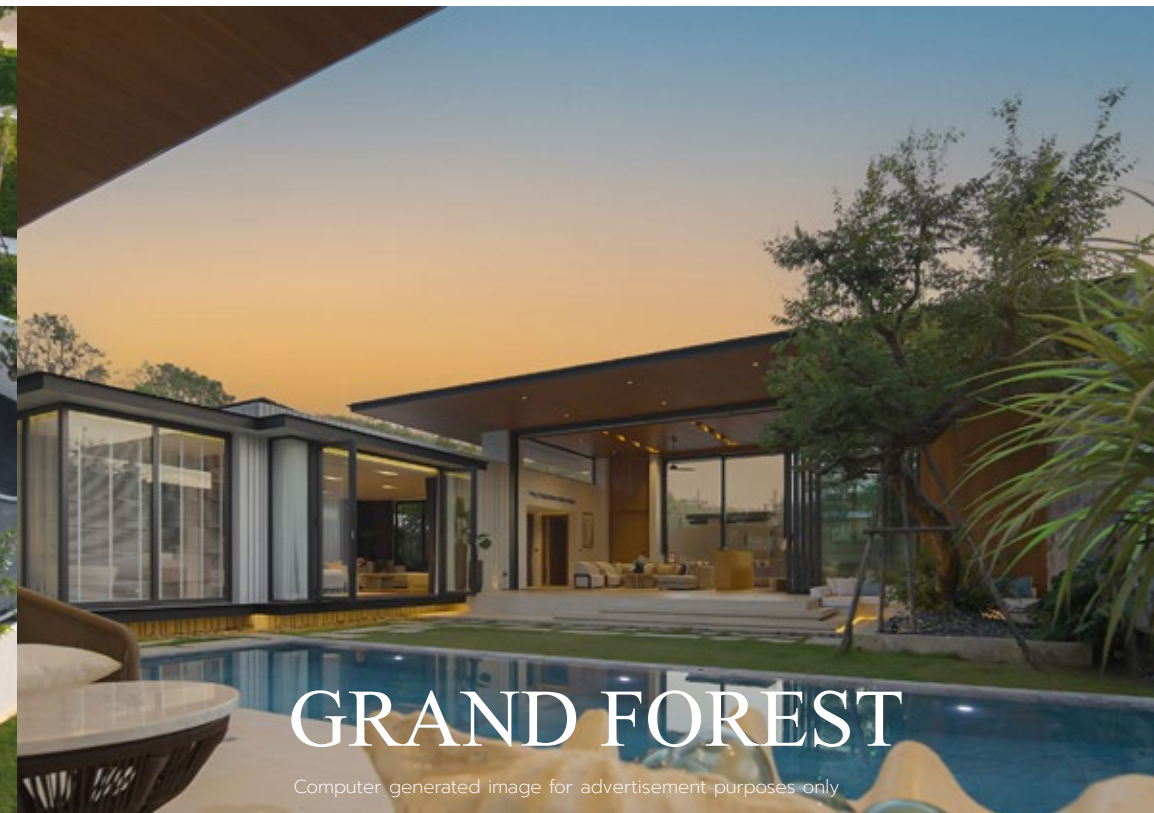



THE BEST FACILITIES BOTANICA GRAND AVENUE



MASTER PLAN

- A** Signage & Feature Gate
- B** Guardhouse
- C** Drop-off Area
- D** Walkway
- E** Driveway
- F** Car Parking
- G** Main Swimming Pool With Lap
- H** Pool
- I** Public Jacuzzi Zone
- J** Kid Pool Area
- K** Party Pool
- L** Clubhouse
- M** Terrace With Day Bed Area
- N** Group Seating
- O** Forest & Swale Zone
- P** Feature Pavilion

- TOWER A**
66 Units 28 Carparks, 2 EV Charger With Parking, 10 Motorbike Parkings, 2 Priority Parkings
- TOWER B**
72 Units 37 Carparks, 2 EV Charger With Parking, 17 Motorbike Parkings 2 Priority Parkings
- TOWER C**
72 Units 76 Carparks, 2 EV Charger With Parking, 27 Motorbike Parkings, 2 Priority Parkings
- TOWER D**
66 Units 30 Carparks, 2 EV Charger With Parking, 21 Motorbike Parkings, 2 Priority Parkings

HYTHE BY BOTANICA

DISCLAIMER: The advertised images and its contents are real and/or be for illustration purposes. Information contained in this sales and marketing material as shown herein are to be used for the purposes of advertising and guideline only. Any information, terms and conditions will be reserved the right to change at any time without prior notice. Reproduction, distribution, photocopy, adaptation, communication to public, publication, exploitation of all or any parts hereof and or retransmission of material contained without permission is prohibited.



Computer generated image for advertisement purposes only



Computer generated image for advertisement purposes only



Computer generated image for advertisement purposes only

BOTANICA PRESTIGE

BOTANICA PRESTIGE

Total Units 7 Villas
 The Land Size Starts 601 - 830 sq.m.
 Built-up Size Starts 373 sq.m.

COMMON AREA

Total Project Area 7,049 sq.m.
 Driving Area 379 sq.m.
 Footpath 602 sq.m.
 Garden Area 195 sq.m.

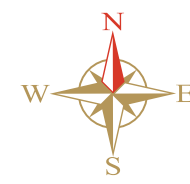

DISCLAIMER: The advertised images and its contents are real and/or be for illustration purposes. Information contained in this sales and marketing material as shown herein are to be used for the purposes of advertising and guideline only. Any information, terms and conditions will be reserved the right to change at any time without prior notice. Reproduction, distribution, photocopy, adaptation, communication to public, publication, exploitation of all or any parts hereof and or retransmission of material contained without permission is prohibited.



Real image with simulated atmosphere for advertisement purposes only



Real image with simulated atmosphere for advertisement purposes only



Real image with simulated atmosphere for advertisement purposes only



BOTANICA FOUR SEASONS

BOTANICA FOUR SEASONS

Total Units 267 Villas
 Total Project Area 154,461 sq.m.
 The Land Size Starts from 459 - 1090 sq.m.
 Built-up Size Starts from 305 sq.m

Common Area 14,456 sq.m.
 Total Project Area 14,456 sq.m.
 Driving Area 3,401 sq.m.
 Footpath 1,133 sq.m.
 Garden Area 11,459 sq.m.
 Sports club 1,413 sq.m.

BOTANICA FOUR SEASONS
 SPRING ZONE

BOTANICA FOUR SEASONS
 SUMMER ZONE

BOTANICA FOUR SEASONS
 WINTER ZONE

BOTANICA FOUR SEASONS
 AUTUMN ZONE



DISCLAIMER: The advertised images and its contents are real and/or be for illustration purposes. Information contained in this sales and marketing material as shown herein are to be used for the purposes of advertising and guideline only. Any information, terms and conditions will be reserved the right to change at any time without prior notice. Reproduction, distribution, photocopy, adaptation, communication to public, publication, exploitation of all or any parts hereof and or retransmission of material contained without permission is prohibited.



BOTANICA WISDOM

BOTANICA WISDOM

Total Units 68 Villas
 The Land Size Starts 461 - 984 sq.m
 Built-up Size Starts 320 sq.m.

COMMON AREA

Total Project Area 49,605 sq.m.
 Driving Area 6,885 sq.m.
 Footpath 2,286 sq.m.
 Garden Area 1,864 sq.m.
 Clubhouse 214 sq.m.



DISCLAIMER: The advertised images and its contents are real and/or be for illustration purposes. Information contained in this sales and marketing material as shown herein are to be used for the purposes of advertising and guideline only. Any information, terms and conditions will be reserved the right to change at any time without prior notice. Reproduction, distribution, photocopy, adaptation, communication to public, publication, exploitation of all or any parts hereof and or retransmission of material contained without permission is prohibited.



Computer generated image for advertisement purposes only



Computer generated image for advertisement purposes only



Computer generated image for advertisement purposes only

BOTANICA MONTAZURE

BOTANICA MONTAZURE

Total Units 36 Villas
 The Land Size Starts 719 - 2,041 sq.m.
 Built-up Size Starts 372 - 1,625sq.m.

COMMON AREA

Total Project Area 49,245 sq.m.
 Driving Area 4,195 sq.m.
 Footpath 1,814 sq.m.
 Green Area 980 sq.m.
 Garden Area 494 sq.m.



DISCLAIMER: The advertised images and its contents are real and/or be for illustration purposes. Information contained in this sales and marketing material as shown herein are to be used for the purposes of advertising and guideline only. Any information, terms and conditions will be reserved the right to change at any time without prior notice. Reproduction, distribution, photocopy, adaptation, communication to public, publication, exploitation of all or any parts hereof and or retransmission of material contained without permission is prohibited.

BOTANICA FORESTA II

MASTER PLAN

Total Units 36 Villas
 The Land Size Starts 475 - 1,535 sq.m.
 Built-up Size Starts 405 sq.m.

COMMON AREA

Total Project Area 36,407 sq.m.
 Driving Area 5,732 sq.m.
 Footpath 2,415 sq.m.
 Garden Area 3,811 sq.m.



DISCLAIMER: The advertised images and its contents are real and/or be for illustration purposes. Information contained in this sales and marketing material as shown herein are to be used for the purposes of advertising and guideline only. Any information, terms and conditions will be reserved the right to change at any time without prior notice. Reproduction, distribution, photocopy, adaptation, communication to public, publication, exploitation of all or any parts hereof and or retransmission of material contained without permission is prohibited.

BOTANICA FORESTIQUE



MASTER PLAN

Total Units 65 Villas
 The Land Size Starts 654 - 1,115 sq.m.
 Built-up Size Starts 318 sq.m.

COMMON AREA

Total Project Area 81,600 sq.m.



DISCLAIMER: The advertised images and its contents are real and/or be for illustration purposes. Information contained in this sales and marketing material as shown herein are to be used for the purposes of advertising and guideline only. Any information, terms and conditions will be reserved the right to change at any time without prior notice. Reproduction, distribution, photocopy, adaptation, communication to public, publication, exploitation of all or any parts hereof and or retransmission of material contained without permission is prohibited.

BOTANICA SKY VALLEY



MASTER PLAN

Total Units 29 Villas
 The Land Size Starts 719 - 1,755 sq.m.
 Built-up Size Starts 547 sq.m.

COMMON AREA

Total Project Area 49,246 sq.m.
 Driving Area 5,062 sq.m.
 Footpath 1,806 sq.m.
 Garden Area 8,359 sq.m.

DISCLAIMER: The advertised images and its contents are real and/or be for illustration purposes. Information contained in this sales and marketing material as shown herein are to be used for the purposes of advertising and guideline only. Any information, terms and conditions will be reserved the right to change at any time without prior notice. Reproduction, distribution, photocopy, adaptation, communication to public, publication, exploitation of all or any parts hereof and or retransmission of material contained without permission is prohibited.



Real image with simulated atmosphere for advertisement purposes only



Real image with simulated atmosphere for advertisement purposes only



BOTANICA LAKESIDE



MASTER PLAN

Total Units 18 Villas
 The Land Size Starts 459 - 1,092 sq.m.
 Built-up Size Starts 305 sq.m.

COMMON AREA

Total Project Area 285,017 sq.m.
 Driving Area 10,421 sq.m.
 Footpath 14,368 sq.m.
 Garden Area 5,938 sq.m.

DISCLAIMER: The advertised images and its contents are real and/or be for illustration purposes. Information contained in this sales and marketing material as shown herein are to be used for the purposes of advertising and guideline only. Any information, terms and conditions will be reserved the right to change at any time without prior notice. Reproduction, distribution, photocopy, adaptation, communication to public, publication, exploitation of all or any parts hereof and or retransmission of material contained without permission is prohibited.



BOTANICA LAKESIDE II



DISCLAIMER: The advertised images and its contents are real and/or be for illustration purposes. Information contained in this sales and marketing material as shown herein are to be used for the purposes of advertising and guideline only. Any information, terms and conditions will be reserved the right to change at any time without prior notice. Reproduction, distribution, photocopy, adaptation, communication to public, publication, exploitation of all or any parts hereof and or retransmission of material contained without permission is prohibited.

BOTANICA MODERN LOFT II

MASTER PLAN

Total Units 54 Villas
The Land Size Starts 462 - 878 sq.m.
Built-up Size Starts 296 sq.m.

COMMON AREA

Total Project Area 36,995 sq.m.
Driving Area 5,184 sq.m.
Footpath 2,222 sq.m.
Garden Area 2,154 sq.m.



DISCLAIMER: The advertised images and its contents are real and/or be for illustration purposes. Information contained in this sales and marketing material as shown herein are to be used for the purposes of advertising and guideline only. Any information, terms and conditions will be reserved the right to change at any time without prior notice. Reproduction, distribution, photocopy, adaptation, communication to public, publication, exploitation of all or any parts hereof and or retransmission of material contained without permission is prohibited.

BOTANICA LOUVRE

MASTER PLAN

Total Units 8 Villas
The Land Size Starts 435 - 560 sq.m.
Built-up Size Starts 336 sq.m.



DISCLAIMER: The advertised images and its contents are real and/or be for illustration purposes. Information contained in this sales and marketing material as shown herein are to be used for the purposes of advertising and guideline only. Any information, terms and conditions will be reserved the right to change at any time without prior notice. Reproduction, distribution, photocopy, adaptation, communication to public, publication, exploitation of all or any parts hereof and or retransmission of material contained without permission is prohibited.



BOTANICA LUXURY HUA HIN



MASTER PLAN

Total Units 30 Villas
 The Land Size Starts 500 - 798 sq.m.
 Built-up Size Starts 300 sq.m.

COMMON AREA

Total Project Area 22,458 sq.m.
 Driving Area 3,595 sq.m.
 Footpath 1,048 sq.m.
 Garden Area 387 sq.m.

DISCLAIMER: The advertised images and its contents are real and/or be for illustration purposes. Information contained in this sales and marketing material as shown herein are to be used for the purposes of advertising and guideline only. Any information, terms and conditions will be reserved the right to change at any time without prior notice. Reproduction, distribution, photocopy, adaptation, communication to public, publication, exploitation of all or any parts hereof and or retransmission of material contained without permission is prohibited.



BOTANICA LUXURY KRABI



MASTER PLAN

Total Units	25 Villas	COMMON AREA			
The Land Size Starts	455 - 774 sq.m.	Total Project Area	17,604 sq.m.	Footpath	715 sq.m.
Built-up Size Starts	310 sq.m.	Driving Area	2,318 sq.m.	Garden Area	878 sq.m.

DISCLAIMER: The advertised images and its contents are real and/or be for illustration purposes. Information contained in this sales and marketing material as shown herein are to be used for the purposes of advertising and guideline only. Any information, terms and conditions will be reserved the right to change at any time without prior notice. Reproduction, distribution, photocopy, adaptation, communication to public, publication, exploitation of all or any parts hereof and or retransmission of material contained without permission is prohibited.





BOTANICA PRU JAMPA

MASTER PLAN

Total Units 87 Villas
 The Land Size Starts 360 - 637 sq.m.
 Built-up Size Starts 280 sq.m.

COMMON AREA

Total Project Area 46,792 sq.m.
 Driving Area 6,899 sq.m.
 Footpath 2,311 sq.m.
 Garden Area 1,590 sq.m.
 Clubhouse 200 sq.m.



DISCLAIMER: The advertised images and its contents are real and/or be for illustration purposes. Information contained in this sales and marketing material as shown herein are to be used for the purposes of advertising and guideline only. Any information, terms and conditions will be reserved the right to change at any time without prior notice. Reproduction, distribution, photocopy, adaptation, communication to public, publication, exploitation of all or any parts hereof and or retransmission of material contained without permission is prohibited.

BOTANICA MODERN SEA KARON

MASTER PLAN

Total Units Phase 1 6 Villas

COMMON AREA

Total Project Area 17,609 sq.m.

Land Area 386 - 772 sq.m.

Usable Area 660 - 702 sq.m.



DISCLAIMER: The advertised images and its contents are real and/or be for illustration purposes. Information contained in this sales and marketing material as shown herein are to be used for the purposes of advertising and guideline only. Any information, terms and conditions will be reserved the right to change at any time without prior notice. Reproduction, distribution, photocopy, adaptation, communication to public, publication, exploitation of all or any parts hereof and or retransmission of material contained without permission is prohibited.

BOTANICA CHALONG BAY



MASTER PLAN

Total Units	28 Villas
Phase 1	13 Villas
The Land Size Starts	459 - 1,298 sq.m.
Usable Area Starts	431 - 645 sq.m.

COMMON AREA

Total Project Area	24,412 sq.m.
Driving Area	2,762 sq.m.
Driving Area & Footpath	4,021 sq.m.
Garden Area	875 sq.m.

DISCLAIMER: The advertised images and its contents are real and/or be for illustration purposes. Information contained in this sales and marketing material as shown herein are to be used for the purposes of advertising and guideline only. Any information, terms and conditions will be reserved the right to change at any time without prior notice. Reproduction, distribution, photocopy, adaptation, communication to public, publication, exploitation of all or any parts hereof and or retransmission of material contained without permission is prohibited.

BOTANICA GREEN BOULEVARD



DISCLAIMER: The advertised images and its contents are real and/or be for illustration purposes. Information contained in this sales and marketing material as shown herein are to be used for the purposes of advertising and guideline only. Any information, terms and conditions will be reserved the right to change at any time without prior notice. Reproduction, distribution, photocopy, adaptation, communication to public, publication, exploitation of all or any parts hereof and or retransmission of material contained without permission is prohibited.

FUTURE PLANS

We are steadfast in our mission to continually enhance our brand and services. Our upcoming initiatives include:

Developing a robust brand identity

Crafting professional and compelling marketing materials.

Implementing a strategic and comprehensive digital marketing plan

Expanding and solidifying our presence in the real estate market

With these significant upgrades, Botanica Luxury Villas is poised to further solidify its leadership and continue to deliver unparalleled luxury living experiences.

DISCLAIMER: The advertised images and its contents are real and/or be for illustration purposes. Information contained in this sales and marketing material as shown herein are to be used for the purposes of advertising and guideline only. Any information, terms and conditions will be reserved the right to change at any time without prior notice. Reproduction, distribution, photocopy, adaptation, communication to public, publication, exploitation of all or any parts hereof and or retransmission of material contained without permission is prohibited.

The Iconic
ONE OF THE BEST FACILITIES IN PHUKET

Clubhouses
RESIDENTIAL FACILITIES AND SOCIAL NETWORKING

The Grove
by Botanica
LIFESTYLE LIVING CENTER

Botanica
Privilege Club
RESIDENTIAL FACILITIES AND SOCIAL NETWORKING

Sales Gallery
MULTIMEDIA SALES GALLERY
AND SALES CENTER

Art Museum
EMOTIONS AND AESTHETICS

BOTANICA PRIVILEGE CLUB

RESIDENTIAL FACILITIES AND SOCIAL NETWORKING



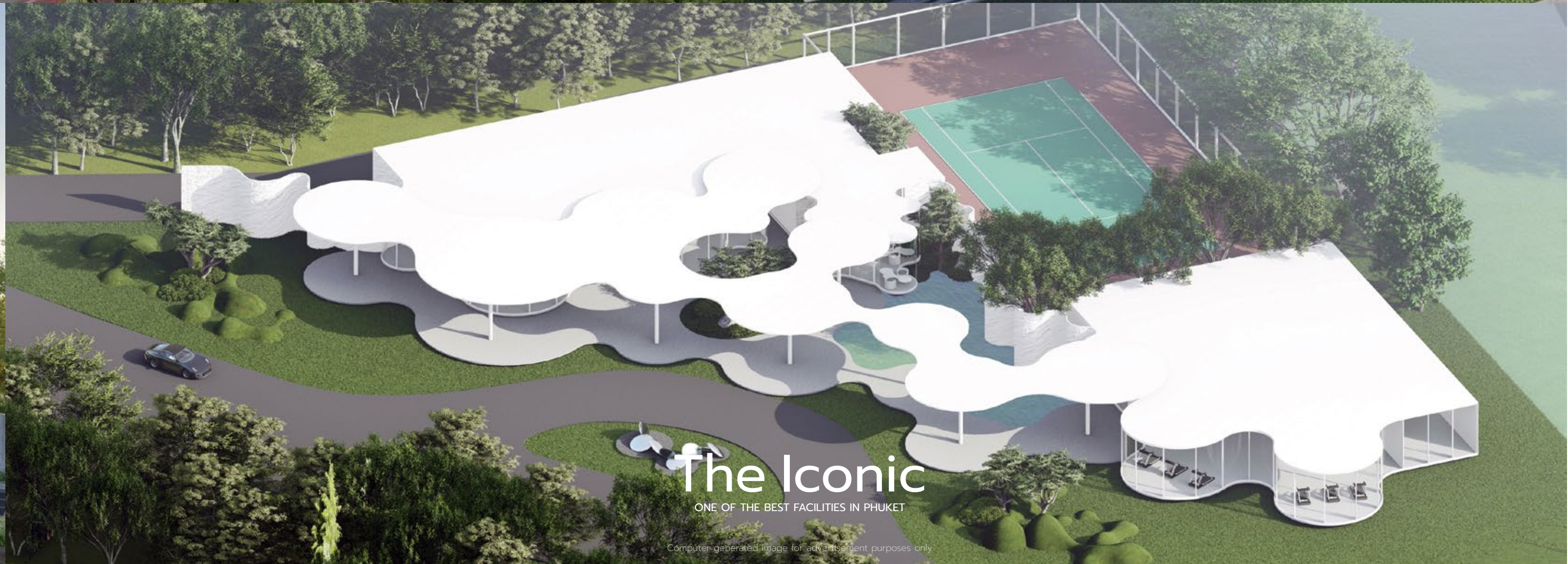



20+
Beach Destination



8+ Hospital and
Healthcare Center



6+
Marina and Local Pier



10+
Shopping Center

POTENTIAL OF PHUKET

- Phuket ranks as the most popular flight destination in the country.
- Asia's Premier Destinations: In 2018, Phuket was honored among the top three destinations in Asia by Trip Advisor's Choice Awards.
- Approximately 300 flights operate daily to and from Phuket.
- Spending Habits: Tourists spend an average of 6,762 Baht per person per day on entertainment, shopping, dining, and accommodation.
- Strong International Spending: Noted for significant spending power from international visitors.
- Booming Development: Witnessing rapid growth with numerous new hotels and other developments.

DISCLAIMER: The advertised images and its contents are real and/or be for illustration purposes. Information contained in this sales and marketing material as shown herein are to be used for the purposes of advertising and guideline only. Any information, terms and conditions will be reserved the right to change at any time without prior notice. Reproduction, distribution, photocopy, adaptation, communication to public, publication, exploitation of all or any parts hereof and/or retransmission of material contained without permission is prohibited.

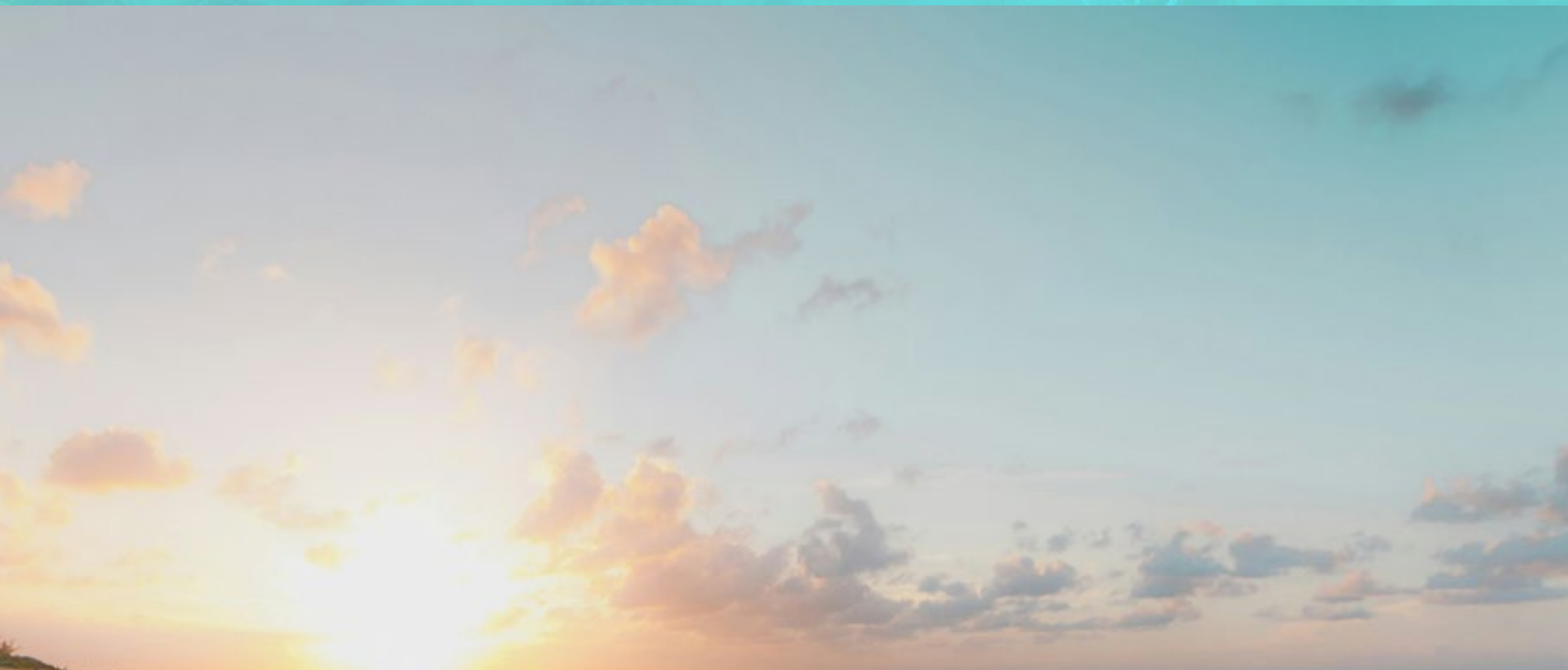

PHUKET

BOTANICA PROJECT ZONE

- A LAYAN BEACH
- B BANGTAO BEACH
- C NAITHON BEACH
- D SURIN BEACH

- E BOAT AVENUE
- F LAGUNA GOLF
- G BLUE CANYON GOLF

- H PORTO DE PHUKET
- I LOTUS'S
- J OLD PHUKET TOWN
- K CENTRAL PHUKET

- L THALANG HOSPITAL
- M ROBINSON LIFESTYLE
- N PHUKET INTERNATIONAL AIRPORT
- O BANGKOK HOSPITAL

DISCLAIMER: The advertised images and its contents are real and/or be for illustration purposes. Information contained in this sales and marketing material as shown herein are to be used for the purposes of advertising and guideline only. Any information, terms and conditions will be reserved the right to change at any time without prior notice. Reproduction, distribution, photocopy, adaptation, communication to public, publication, exploration of all or any parts hereof and or retransmission of material contained without permission is prohibited.



NEW PROJECT
BANGTAO

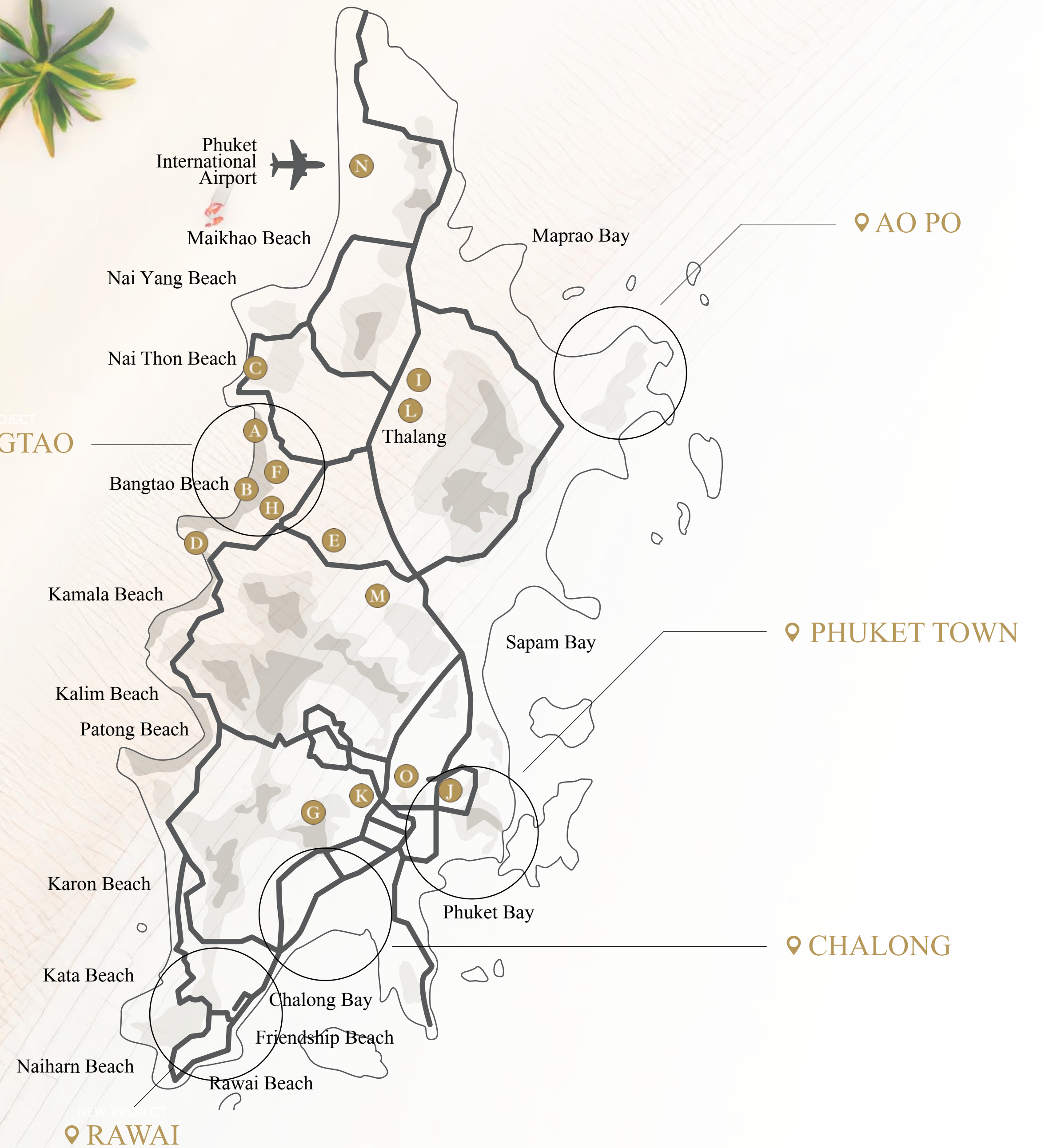

AWARD AND RECOGNITIONS

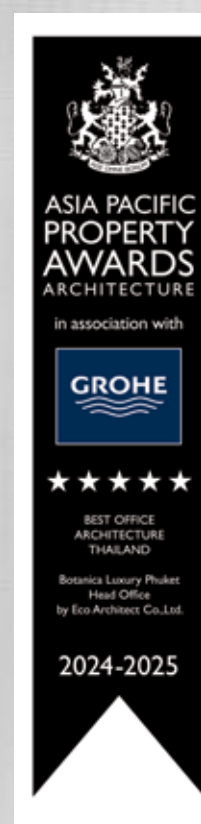
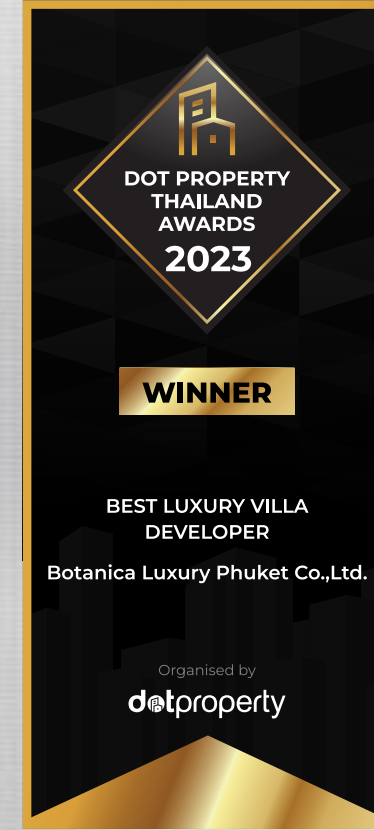
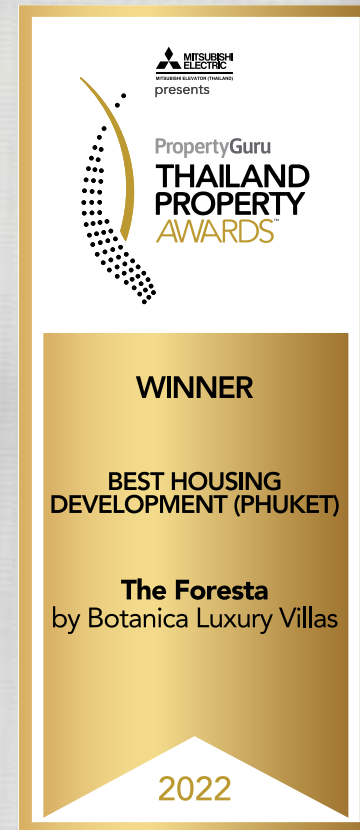
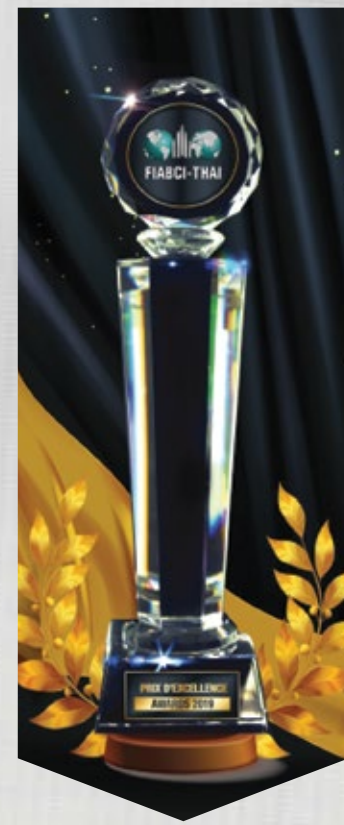



BOTANICA LUXURY PHUKET

199/9 Moo.4 Thepkasattri Sub-district, Thalang District, Phuket, Thailand 83110

Sales Office: +66 (0)9 8394 7097 info@botanicaluxuryvilla.com www.botanicaluxuryvilla.com

Disclaimer: whilst every care has been taken in preparing the sales information and artists' digital and artistic impressions in this brochure, the developer does not guarantee their accuracy nor intends them to form any part of an offer or contract. The developer also reserves the right to make changes to the residence designs presented herein at any time, at its own discretion and without prior notice to prospective buyers.